

Part #007-0721-002



SpeedStream® DSL Modem

Quick Start Guide

Before you begin:

Verify that the following items came with your DSL kit:

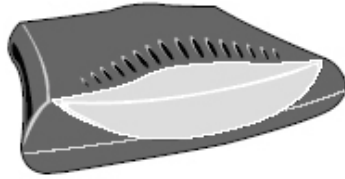

SpeedStream
DSL modem



Documentation



Power supply



RJ-11
DSL cable



RJ-45
Straight-through
Ethernet cable

Your service provider may include a wall-mount filter, two-to-one adapter(s), line filter(s), and an Ethernet adapter in your DSL kit. If you received any of these items, follow the instructions provided in this guide for basic installation. If you need further assistance installing these items, please contact your service provider.

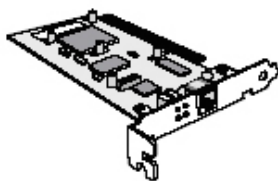

PCI Ethernet adapter



Line filter(s)

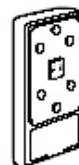

Wall-mount line filter



Two-to-one adapter(s)

Step 1 Install Line Filters

Devices such as fax machines, caller ID boxes, or phones that share the same phone line as your DSL account require a line filter, which prevents noise from disrupting the DSL signal on the phone line. Filters can be in the form of a stand-alone line filter or a wall mount filter. A filter can also be plugged into a two-to-one adapter if your SpeedStream DSL modem will share the same phone jack with another device.

Stand-alone Line Filter

For each device that shares the DSL phone line:

1. Unplug the device's cord from the phone jack.
2. Plug the filter into the phone jack.
3. Plug the phone cord (or other device cord) into the filter.

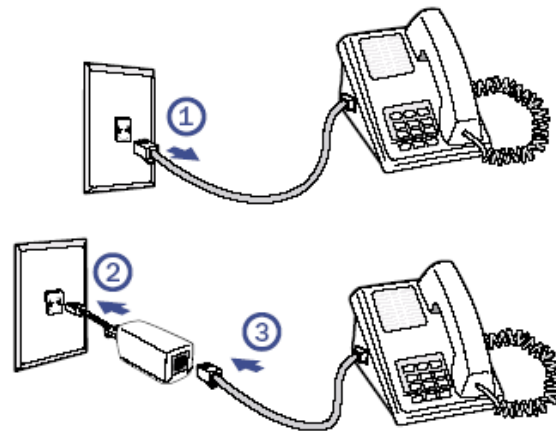

Wall Mount Filter

For a wall mount phone, install a wall mount filter:

1. Remove the phone.
2. Connect the wall mount filter to the wall plate.
3. Reconnect the phone.

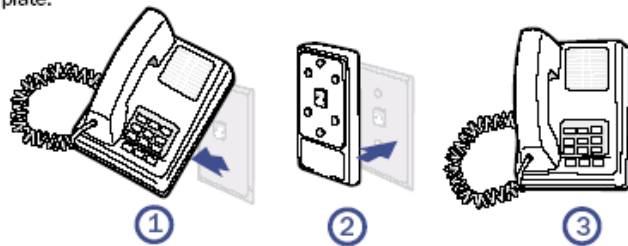

Two-to-One Adapter

If your SpeedStream DSL modem and another device will share the same phone jack, install a two-to-one adapter:

1. Plug adapter into the phone jack.
2. Plug a line filter into one of the sockets of the two-to-one adapter. The other socket will be used to connect the DSL cable.
3. Plug the telephone (or other device) cord into the line filter.

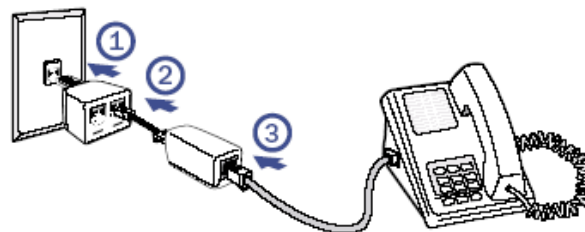

Step 2

Ethernet Installation Method

The SpeedStream® DSL modem may be connected to either an existing USB port or an Ethernet port. If you choose to attach the SpeedStream® modem via the Ethernet interface, it is only necessary to complete the steps in Option A. Otherwise, proceed directly to Option B for USB installation.

Install Ethernet Adapter

You will need to install an Ethernet adapter if your computer does not already have one installed. Refer to your Ethernet adapter manufacturer's documentation for complete installation instructions.

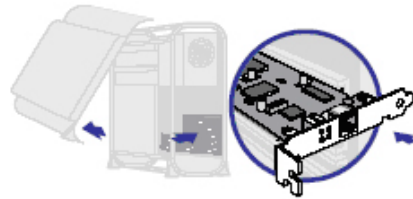

Connect the SpeedStream DSL Modem



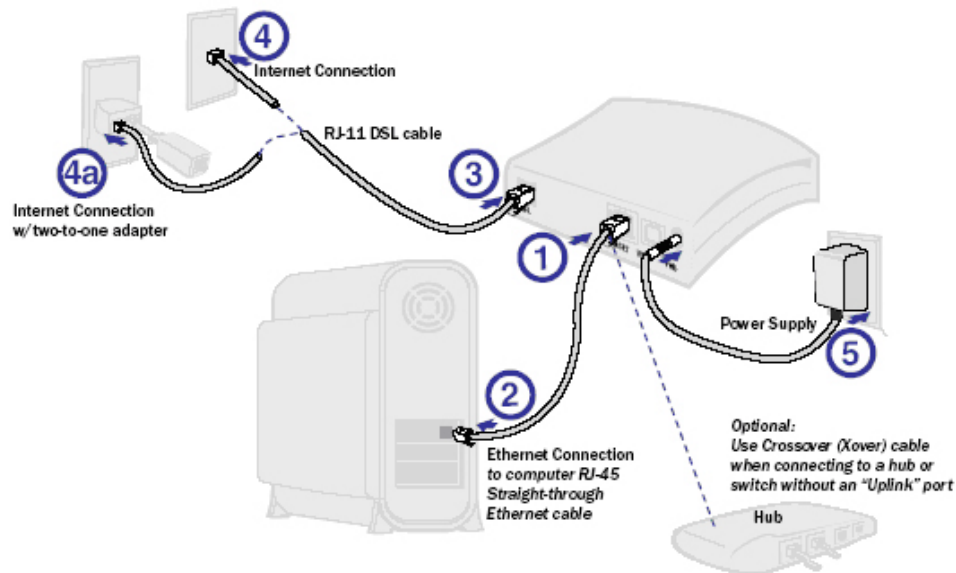

1. Connect the straight-through Ethernet cable to the Ethernet port on the modem.
2. Connect the other end of the straight-through Ethernet cable to the Ethernet port on your computer.
3. Plug the DSL cable into the DSL port on the modem.
4. Plug the other end of the DSL cable into the phone jack.
- 4a. If using a two-to-one adapter, plug the cable into the open socket of your two-to-one adapter.
5. Plug the power adapter into the power outlet and modem.

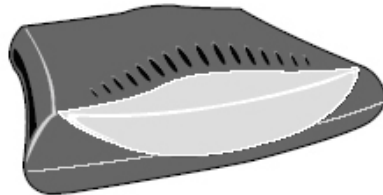

You have completed the installation of your SpeedStream® hardware; there is no modem software installation required when using the Ethernet connection method.

Step 3 Troubleshooting



LED	Off 	Green 	Blinking Green 	Red 
PWR	Power not applied	Normal system operation	N/A	Self test failure if RED longer than 30 seconds
DSL	Power not applied– DSL signal not detected	DSL Line is trained and ready for data traffic	Steady Blinking -DSL is training Blinking - User traffic flowing in either direction	N/A
USB	Power not applied– USB not connected	USB connected	USB user traffic flowing in either direction	N/A
ENET	Power not applied– Ethernet not connected	Ethernet connected	Ethernet user traffic flowing in either direction	N/A

For more Technical Support please call:
706-754-9094 or 877-651-3157
Hours Monday-Friday 8:00AM-12 Midnight
Saturday 9:00AM - 7:00PM
Sunday 1:00PM-7:00PM

For more information about Efficient Networks or our products, please visit our website

www.efficient.com

Corporate Headquarters

4849 Alpha Road
 Dallas, Texas 75244

1+972-852-1000 PHONE
 1+972-852-1001 FAX

info@efficient.com EMAIL



©2002 Efficient Networks, Inc. All rights reserved. Efficient Networks, its logos, and SpeedStream are registered and unregistered trademarks of Efficient Networks, Inc. All other brand names and trademarks are held by their respective companies. Efficient Networks reserves the right to make changes to product specifications at any time without notice.